

REPAIR KIT FOR REAR WIPER MOTOR - Defect: Rotating nozzle

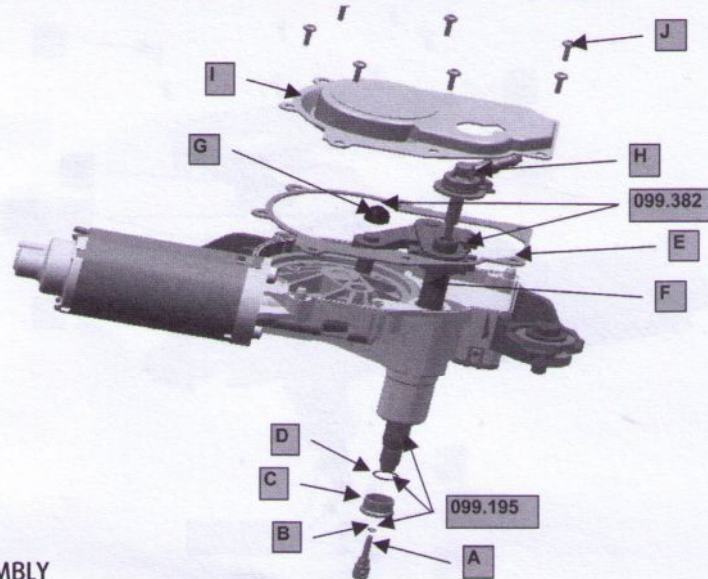

Pic. 1

MOTOR DISASSEMBLY

- Take apart the nozzle (A) from the shaft, scrap them.
- Unscrew screws (J), take apart metal cover (I) with water connector (H).
Take apart water connector (H) from cover, and scrap it.
- Take apart paper gasket (E) and scrap it.
- Take apart plastic thrust pad (G), assembly shaft (F) holding the wheel and scrap both of them.
- Take apart bush (C), o-ring (D) and scrap both.

MOTOR RE-ASSEMBLY

- Assemble assy. wiper shaft (F) putting the pin in the wheel hole (see picture 1).
- Put grease 099382 (3,5 g.) over the teeth of the assy. Wiper shaft (F).
- Put grease 099382 (0,5 gr) on the pin of assy. wiper shaft (F) and insert plastic thrust pad (G).
- Put grease 099382 (0,5 gr) over the plastic thrust pad (G).
- Assemble new paper gasket (E) over the plastic housing.
- Assemble new water connector (H) through the inner side of the metal cover (I).
- Assemble metal cover (I) with water connector (H) in the motor over the paper gasket (E) and through the shaft (F).
- Fix metal cover with screws (J). applying tightening torque of $0,8 \pm 0,2$ Nm.
- Put grease 099195 (0,5 grs) over the o-ring (D) and assemble it around wiper shaft towards the bottom of the plastic dome
- Put grease 099195 (0,5 grs.) around wiper shaft over the o-ring and assemble bush (C) around the shaft until the it gets at the level of the plastic dome.
- Put grease 099195 on o-ring (B) and assemble it between shaft (F) and tube (H), towards the bottom.
- Assemble nozzle (A) over the tube of the water connector (H) and wiper shaft (F) at an angle of 25° (see Pic. 2).
- Assemble and fix the motor to the tailgate of the vehicle. Run the rera wiper motor. Drive to park position. Assemble and fix wiper arm to motor shaft.

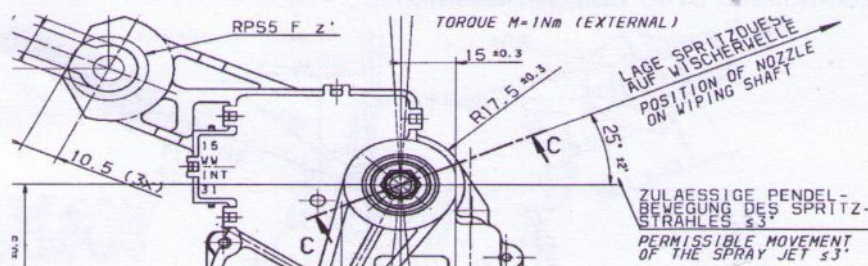

Pic. 2